

KEA **maker lab**



MakerLab Sticker Printer Roland BN2-20

User Guide

English

v. 5

0.1 Don't turn off the sticker printer

The sticker printer should never be turned off.

Ever.

When it is on it keeps cleaning itself automatically because if it does not do this then the white ink dries up and breaks the printer.

This costs thousands to fix.
So don't turn it off.

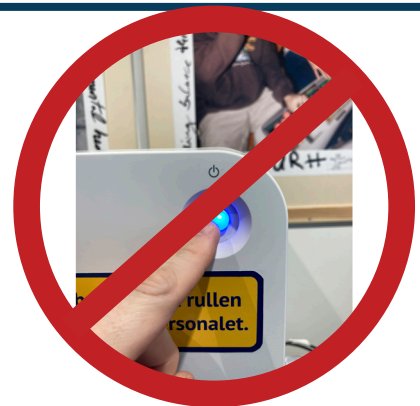

1

PROGRAM: Adobe Illustrator PREPARING YOUR DESIGN

1.1

Put your design on a USB-stick. You can borrow them from MakerLab. They are on the orange board in the main room. Our USB-sticks have both normal USB ports and USB-C. Alternatively email your file to yourself, log in and download the file on the sticker printer computer.

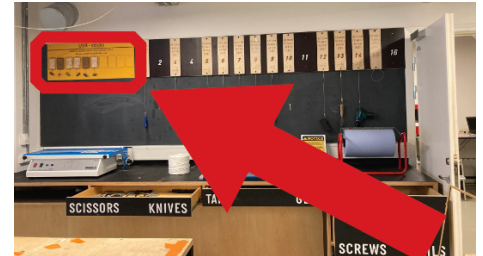

1.2

On the computer next to the sticker printer you open your design in Adobe Illustrator.

If you need 45 copies of something then **JUST** make one design in Illustrator. Don't lay them all out next to each other. There is a much easier way we will use later.

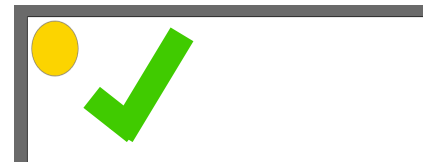

1.3

Select your entire design, right click it and click "Copy".



1

PROGRAM: Adobe Illustrator PREPARING YOUR DESIGN

1.4

Now go to:

File → New from template

→ Sticker Printer Template.ait

This will open the MakerLab Illustrator template for the sticker printer in a NEW file, inside Illustrator.

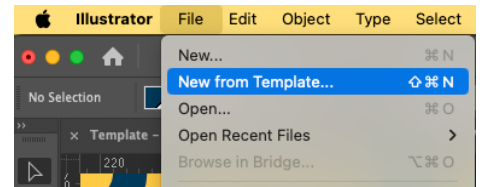

1.5

In the template file you just opened right click the empty, white canvas, then click “Paste”.

Your design should now appear.

The artboard of our template has the same width as the Sticker Printer’s paper roll, so you can see if it fits.

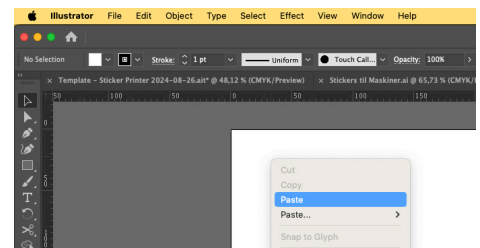

1.6

The sticker printer can cut out your stickers for you.

You can do this in 2 ways:

1. A simple way
2. A fancy way

This guide describes both. First, the simple way on the next page.

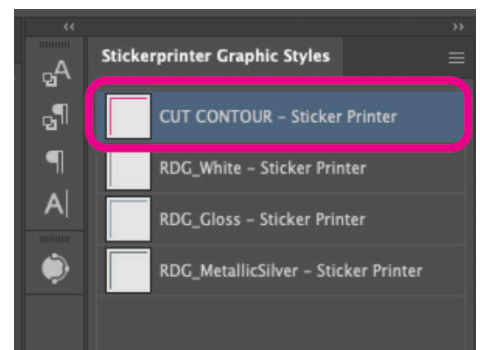

2.1 Cut Contours Simple

Pick the rectangle tool and draw a box around your sticker design.

It can also be a circle, ellipsis or any other shape.

This is the easiest option if your design is an image and not a vector.

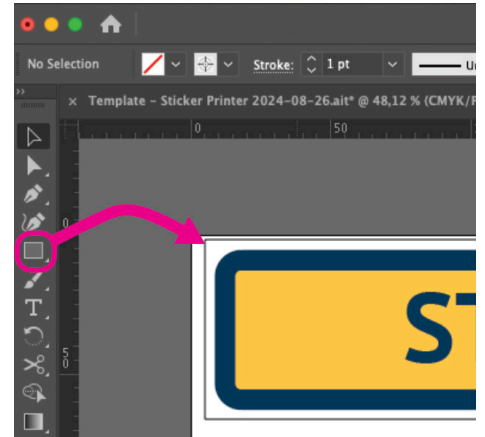

2.2 Cut Contours Simple

Select the box you drew and click the CUT CONTOUR swatch.

This makes the box magenta.
Make sure the Cut Contour line has a stroke of 0.25mm.
This is the line that the printer will cut. Please use the Sticker Printer Graphic Style called "Cut Contour" from the template so it's right.

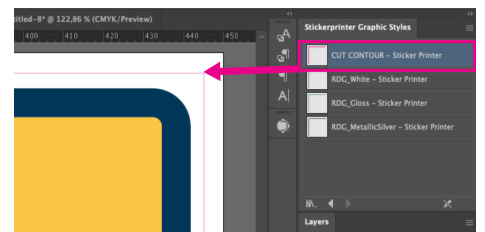

2.3 Cut Contours Simple

If just having a simple box around your sticker is enough for you then you can continue to

Step 3: Preparing to Print

If you want a nice contour cut that is closer to your design then keep reading.



2.1a Cut Contour Fancy

If you want a nice outline around your sticker that follows its shape then do the following:

If your design is already a vector then you can just select its outline and then pick

Object → Path — Offset Path

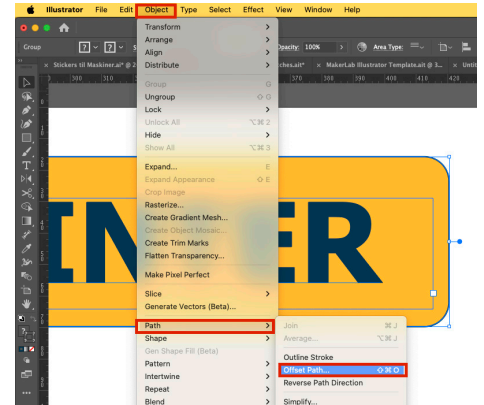

2.2b Cut Contour Fancy

The outline will appear on either the outside or inside.

If your offset is positive (eg. 2mm) then it will be on the outside of your design .

If it is negative, eg. -1mm, then it appears on the inside.

Don't worry about Joins and Miter limit.

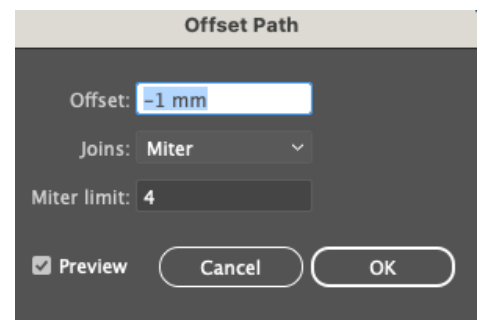

2.3b Cut Contour Fancy

Top pictures has a negative offset of -0,75mm. This makes the cut eat into your design a tiny bit so the edge colour of your sticker is the same as your design.

Use -0,75mm offset if you want this.

Bottom pictures has a positive offset. This will create a white border around your sticker.

Use 2mm offset or more for this.



2.4a Cut Contour Fancy

After making the outline it will automatically be selected, so you can click the “Cut Contour” in the Sticker Printer Graphic Styles menu.

This tells the printer that you want that line cut.

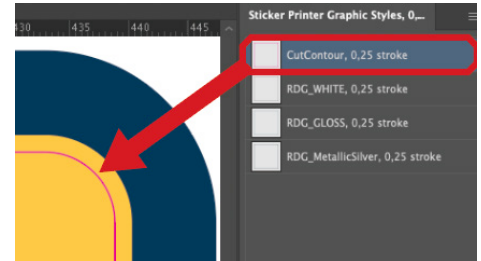

3 PROGRAM: Illustrator

Save as .EPS file

3.1

Now that you have your cut contour lines done in Illustrator you save the design as an .EPS file.

File → Save As... → Format
→ Pick Illustrator EPS

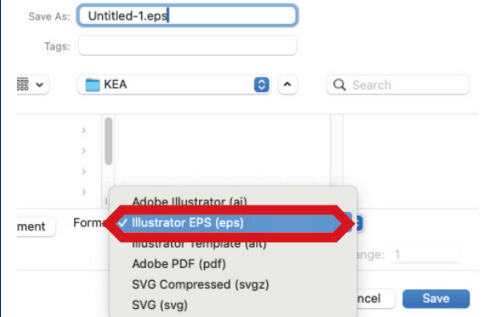

3.2

Illustrator will ask you about a bunch of stuff.

It doesn't matter.

Just click "Ok".

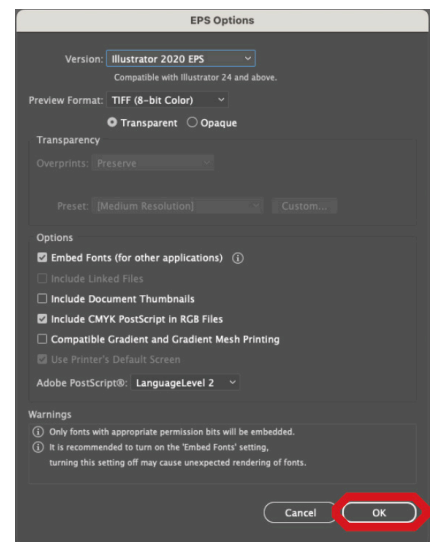

4 PROGRAM: VersaStudio PREPARING TO PRINT

4.1

Open VersaStudio.

This program tells the sticker printer what to do.



4.2

Add the .EPS file you just made to the relevant queue.

Queue A = Glossy Paper
Queue B = Matte Paper
Queue C = Transparent "Paper"

File → Add to Queue A / B / C

If you want to change the paper type then ask the MakerLab staff.
Don't do it yourself.

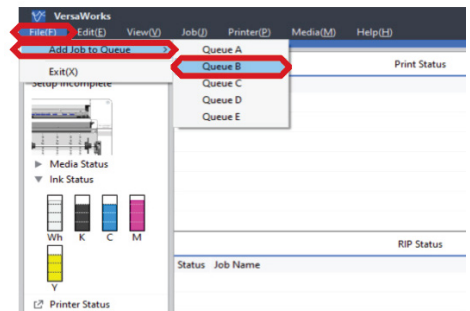

4.3

If there are other designs in the queue then right click them and click "Delete".

You do not need to ask anyone's permission to do this.
ONLY your design should be in the queue.

Now double-click the name of your file in the queue.

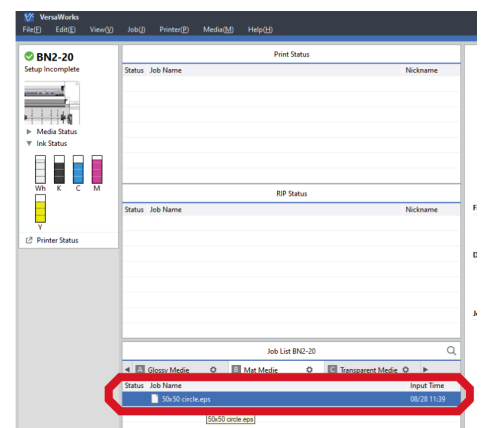

4 PROGRAM: VersaStudio PREPARING TO PRINT

4.4

Go to “Layout” and change the “Copies” to the amount of stickers you want.

The program lays them out automatically. It does this from the center of the page and outwards.

This is why you start with a single design, instead of making 40 copies in Illustrator.

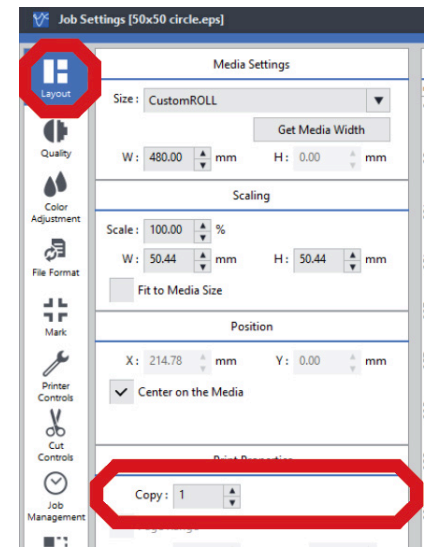

4.5

Look at the outlines of your design.

If there is a dotted line around them that moves this means that the printer will cut there. If it isn't red, dotted and moving then something went wrong with the Cut Contours from Step 2.2 and the printer won't cut.

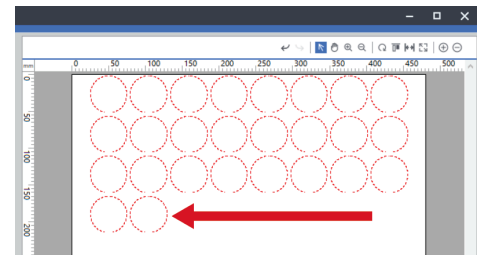

4.6

You can also see how long the printed sheet will be on the ruler to the left.

This is handy since you pay by the meter.

Don't worry about the poor resolution in the preview to the right. It will be nice when you print it if your design was nice.

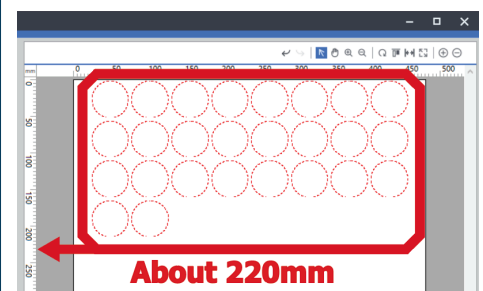

4 PROGRAM: VersaStudio PREPARING TO PRINT

4.7

If there is some extra room on the last line you might as well increase the number of copies so the whole sheet is used so you have a few extra stickers just in case.

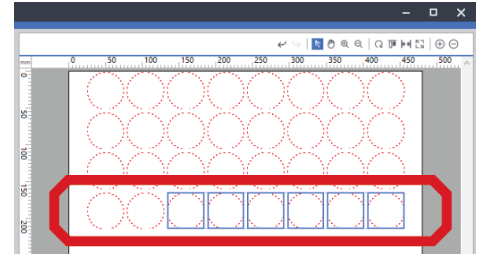

4.8

To see how long the print and cutting will take click on “Quality”.

“Normal” is picked by default. Leave it like that. It will say how long the design will take.

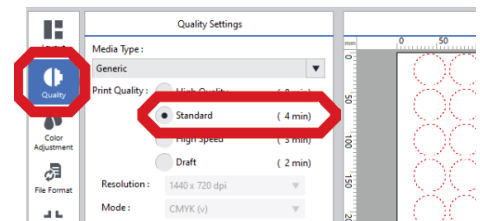

4.9

Click “Ok”

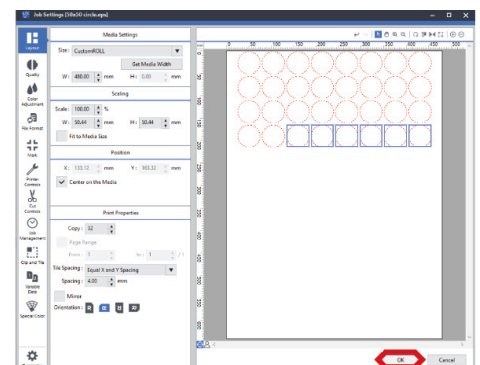

4 PROGRAM: VersaStudio PREPARING TO PRINT

4.10

When you click the Printer Icon it will start the print.

The Sticker Print will **FIRST** print all your stickers. Then it pushes the paper all the way out. Then it will pull the paper back in and cut them out for you.

Do not interrupt or stop the printer when it's doing its thing.

4.11

You are ready to print.
Hit the printer icon and the printer starts.

When it is done printing and cutting your stickers out it will then cut off the entire sheet for you.

Please don't cut it yourself with a hobby knife.

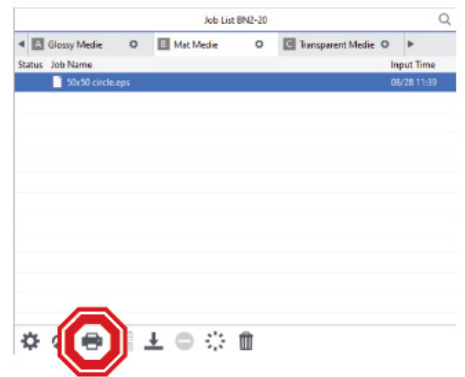

5 PROGRAM:Real Life

Getting stickers off the paper

5.1

If you simply scratch around the edges of the stickers then you probably get ugly wrinkles where you scraped it with your nail.



5.2

Instead lift the corner of all the stuff that is NOT your stickers. Then pull all of it off, slowly, and flatly like the picture.

Keep pulling it off as flat and close to the stickers as you can.

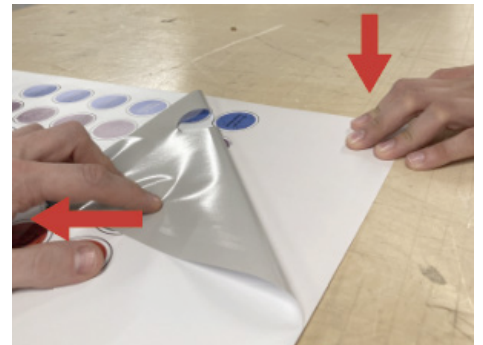

5.3

Avoid lifting it up high over the stickers like in the picture because if it falls down on your stickers they will stick to its underside.

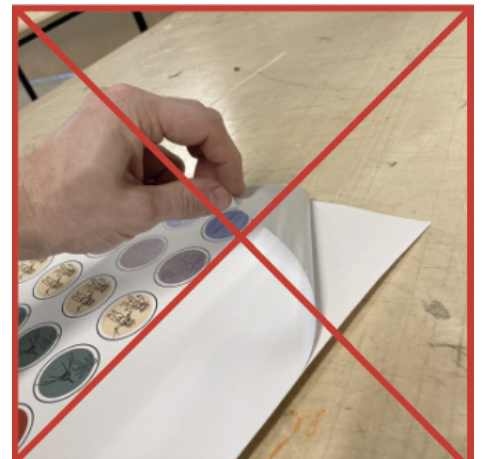

5 PROGRAM:Real Life

Getting stickers off the paper

5.4

When only your own stickers are left on the sheet then you can roll it underneath your stickers to lift them slightly.



5.5

Then you can easily lift them off without marking them in any way so they look fresh and clean.



STICKER PRINTER TROUBLESHOOTING

Error	Cause	Solution
<p>The printer doesn't cut your stickers.</p> <p>And it may actually print your cut contours as a magenta line instead of cutting it.</p>	<p>Something is wrong with the Cut Contour line.</p> <p>It isn't the right, exact colour, the stroke is wrong or the color type is not "Spot Color".</p> <p>Or all 3.</p>	<p>Use the Illustrator template on the sticker printer computer or download it from the MakerLab website.</p> <p>Select the line you want cut and then apply the CUT CONTOUR graphic style to it.</p> <p>See Step 2.2</p>

<p>The printer takes a long time to cut because it's cutting two lines around each sticker.</p>	<p>The stroke of your cut contour is too large.</p>	<p>Select your cut contours and use the CutContour graphic style from the MakerLab Sticker Printer Template.</p> <p>Alternatively manually set your cut contours to 0.25 stroke</p>
---	---	---

<p>The printer is cutting your stickers, but they are hard to peel off or it isn't cutting all the way through</p>	<p>The printer's knife needs adjusting.</p>	<p>Contact the Maker-Lab staff and ask for help on how to do this.</p> <p>Don't do it yourself.</p>
--	---	---

STICKER PRINTER TROUBLESHOOTING

Error	Cause	Solution
NOT PRINTING You click the “Print” Icon, but nothing happens	The printer was probably sleeping and it takes a while to wake-up and heat up.	Just wait another 5 minutes.

The printer finishes printing everything, but then just keeps pushing the sticker paper out and it doesn't cut it. DON'T STOP THE PRINTER when this happens. It's supposed to happen.	The ink is just drying. Nothing is wrong.	Wait longer and it will suck the paper back in and start cutting out your stickers. And ultimately cut the sheet with your stickers free too.
---	--	--

ICON BANK

